

OPERATOR'S MANUAL

670014

INCLUDE OPERATOR'S MANUAL: 66605X-X 1/2" Diaphragm Pump (PN 97999-99)

RELEASED: 11-15-00

REVISED:
(REV. A)

670014 1/2" DIAPHRAGM PUMP (WITH POLYPROPYLENE FLUID SECTION)

Model 670014 is similar to a Model 666053-0D2 Diaphragm Pump, therefore a 66605X-X Operator's Manual should be used for General Information, Installation, Operation, and Maintenance. This pump uses Duckbill style checks.

USE SERVICE KITS:

637141 for Air Section

637140-D2 for Fluid Section

INSTALLATION NOTE: This pump has the inlet on the bottom and outlet on the top, a shortened pilot rod, and a different muffler and cover. It also includes a 92818 Needle Valve (not shown).

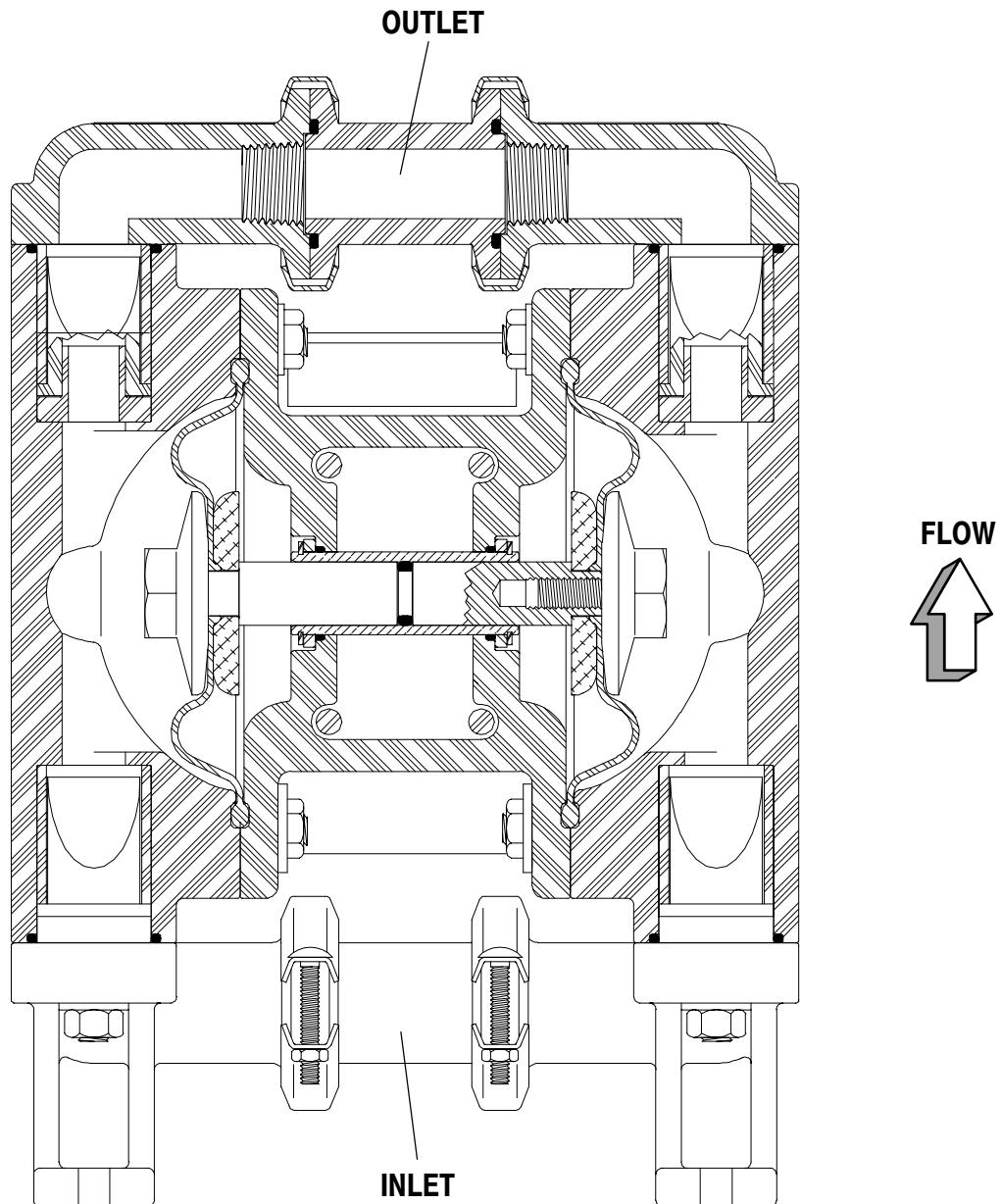

670014 1/2" DIAPHRAGM PUMP

